

THE INFORMATION CONTAINED IN THIS DRAWING IS THE SOLE PROPERTY OF DYNETIC SYSTEMS. ANY REPRODUCTION IN PART OR WHOLE WITHOUT THE WRITTEN PERMISSION OF DYNETIC SYSTEMS IS PROHIBITED.

REV	ECO #	DESCRIPTION OF CHANGE	BY	DATE	CHD
A	1896	RELEASE	MLV	19-May-2008	JL

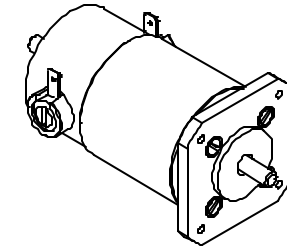

DIRECTION OF MOTOR ROTATION WITH + APPLIED TO TERMINAL #1 AND VIEWED FROM THIS END CW

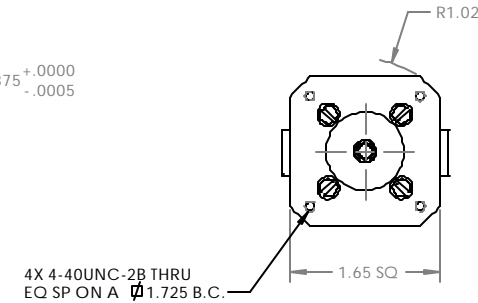
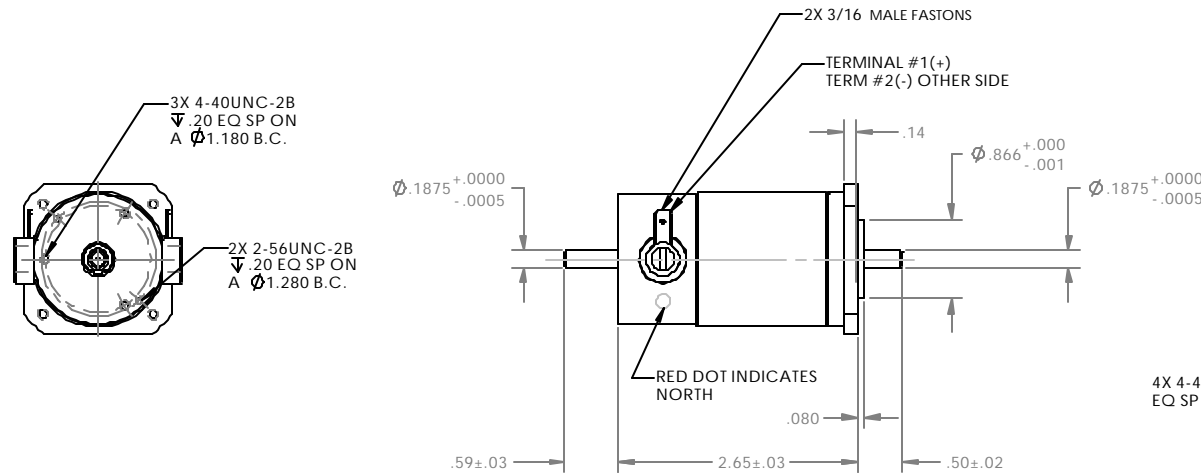

MOTOR CHARACTERISTICS			
RATED VOLTAGE D.C.	24	VOLTS	
RATED CURRENT	1.68	AMPS	
RATED TORQUE	6	OZ-IN	
RATED SPEED	6700	RPM	+/-15%
RATED POWER OUT	30	WATTS	+/-15%
NO LOAD SPEED	8000	RPM	+/-15%
NO LOAD CURRENT	0.27	AMPS	MAX
BACK EMF CONSTANT	2.7	V/KRPM	+/-10%
TORQUE CONSTANT	3.65	OZ-IN/AMP	+/-10%
DC ARMATURE RESISTANCE AT 1.5 AMPS	2.7	OHMS	+/-15%
STATIC FRICTION	0.5	OZ-IN	MAX
ENDPLAY WITH 5 POUND REVERSING	0.005	INCHES	MAX
SHAFT TIR	0.001	INCHES	MAX
ARMATURE INERTIA	0.0006	OZ-IN/SEC ²	REF

OPERATING LIMITS			
SPEED	10000	RPM	MAX
ARMATURE TEMPERATURE	155	DEGREES C	MAX

NOTES:

1. DOUBLE SHIELDED OR SEALED BALL BEARINGS, ABEC CLASS 3.
2. SHAFT MATERIAL 303 STAINLESS STEEL.

UNLESS OTHERWISE SPECIFIED: DIMENSIONS ARE IN INCHES. TOLERANCES ARE AS FOLLOWS FRACTIONS DECIMALS ANGLES HOLE FINISH	DO NOT SCALE DRAWING	DYNETIC SYSTEMS Elk River, Minnesota MS1509L-24/11 MOTOR/N17 C 509424 REV A
	APPROVALS MLV CHECKED	
MATERIAL	BREAK CORNERS OUTSIDE: .020 MAX/.005 MIN. INSIDE: .016 MAX RADIUS	SCALE 1:1
THIS IS A SOLIDWORKS FORMAT DRAWING		SHEET 1 OF 1